

Protest Map: Zoning Case Z1118-0078

200-ft Notice Area = 375,225.82 square feet
Area Opposed = 78,269.26 square feet
Percentage = 20.86%

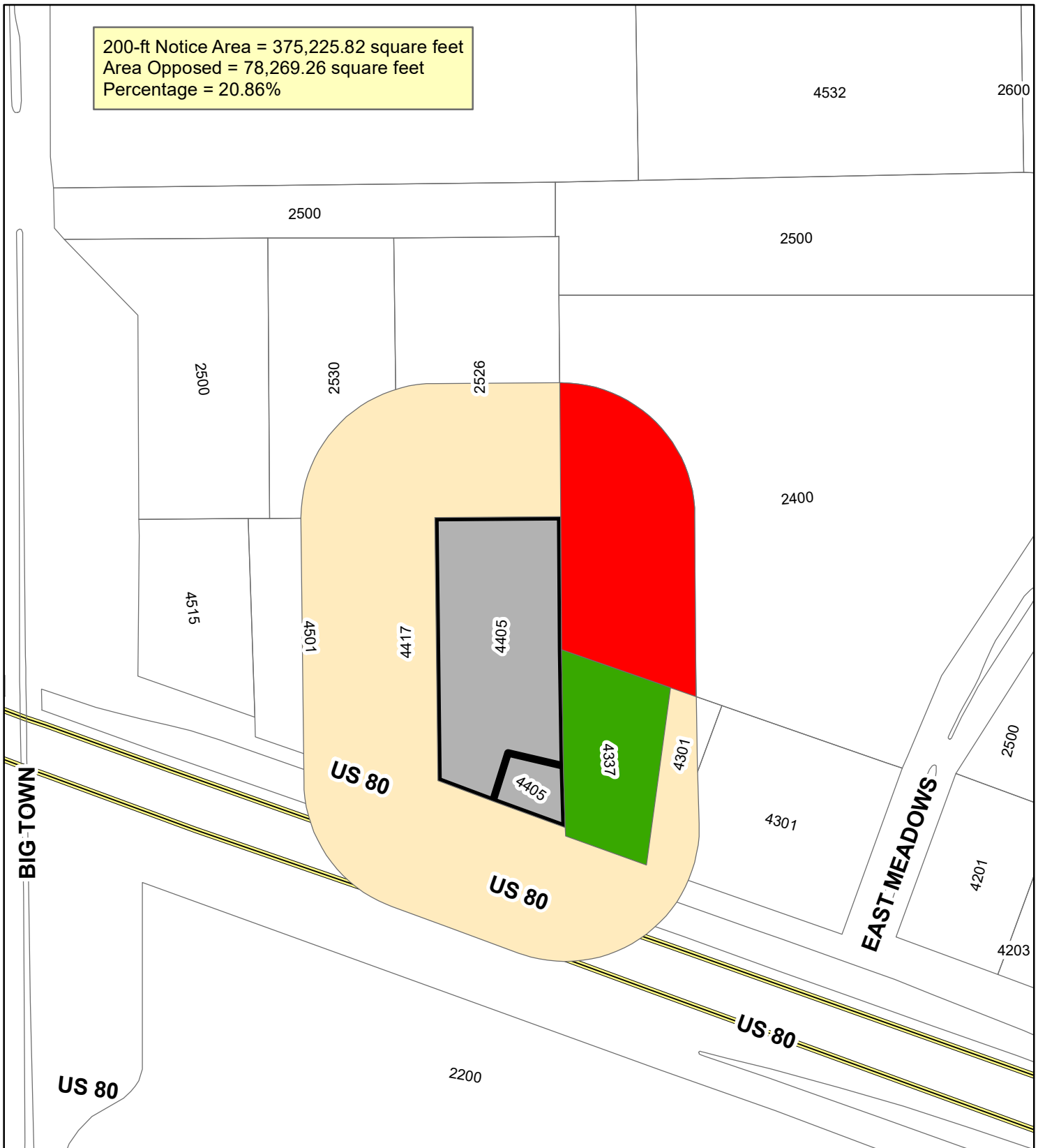

Request: Rezoning from C, Commercial within the Skyline Logistic Hub Overlay District to C, Commercial within the Skyline Logistic Hub Overlay District with a Conditional Use Permit to allow a limited service motel.
Applicant: Lance H. "Luke" Beshara on behalf of Tejas Motel, L.L.C.
Location: 4405 E. US Highway 80

