

# ALCOHOL MEASUREMENT PLAT

LA MICHOCANA SUPERMARKET #12  
5200 Gus Thomasson Road, Suite 100  
Mesquite, Tx. 75150  
Mapsco Page 39-K  
LMMM Dallas #12, LTD

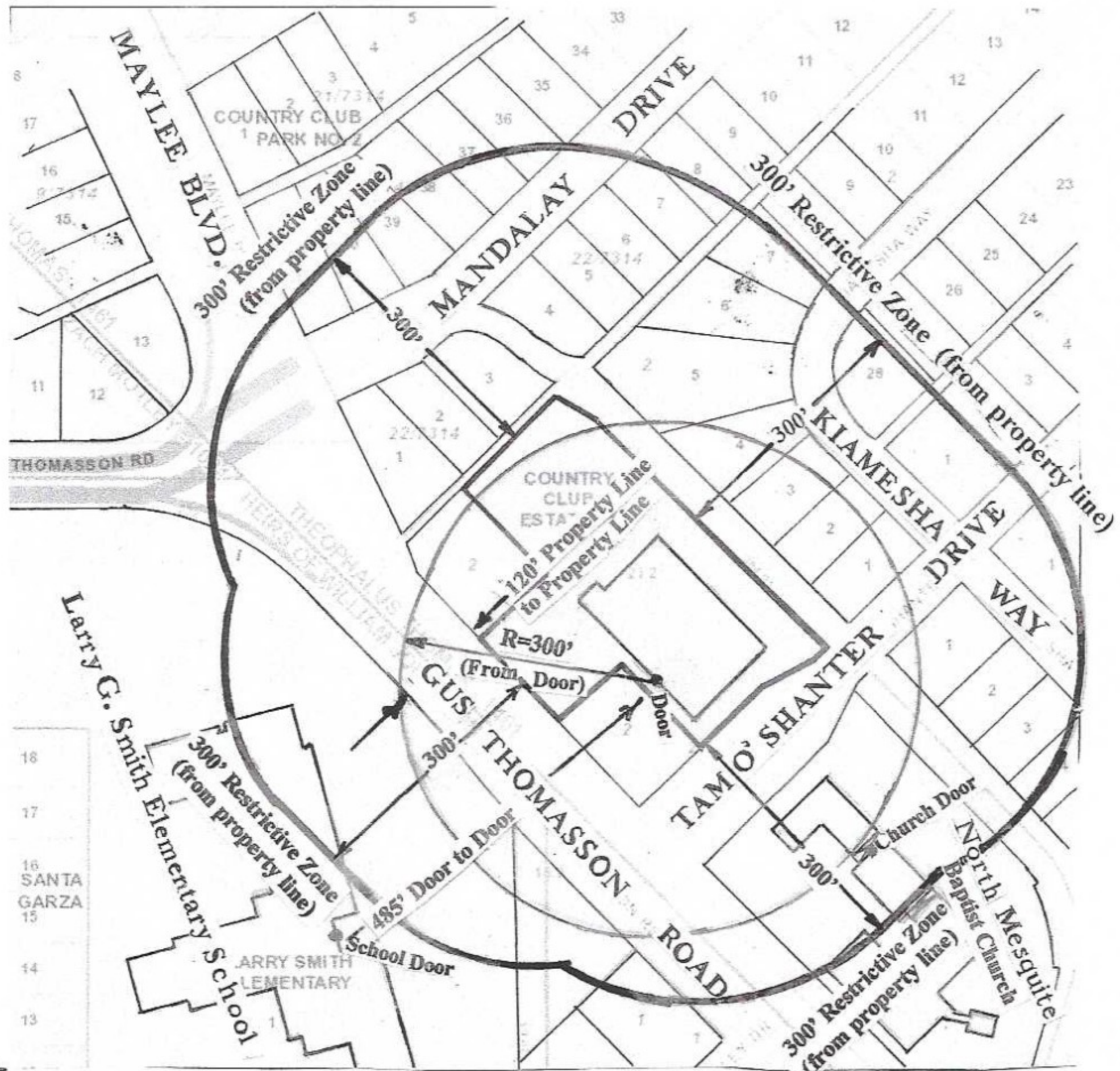

I have conducted (or caused to be conducted) a physical inspection of the area and a diligent search of public records to determine if the place of business is located near any protected uses. This survey map shows that the place of business where alcoholic beverages will be sold meets the location requirements in Code of the City of Mesquite, Texas, Article XI, Sec. 8-840.

The LA MICHOCANA SUPERMARKET #12, located at 5200 Gus Thomasson Road, Suite 100, in the City of Mesquite, is within 300 feet of a church, public or private school, day care center, child care facility or a public hospital as defined in Code of the City of Mesquite, Texas, Article XI, Sec. 8-840.

C = Commercial  
R = Residential  
V = Vacant

Date 5/10/2021  
Job 21-283

This survey was performed for an alcohol-measurement certification. All improvements may not be shown as existed at the time of survey. Research of protected properties included a search of appraisal district records, parole evidence of the owner/manager and a physical inspection on the ground.



*Ben E. Rychlik*  
Registered Professional Land Surveyor 1630  
**SURVEYING ASSOCIATES**  
1018 S. Beckley, Dallas, Tx. 75203  
Phone: (214) 948-3324  
Fax: (214) 946-7540  
FIRM Registration / License No. 10040200